

**Fuel Module, 5.2L (ELF), 5.9L Light Duty (EML), 5.9L Heavy Duty (EMM), 8.0L (EWA), 5.9L Diesel (ETC,ETH)  
Figure 014-510**

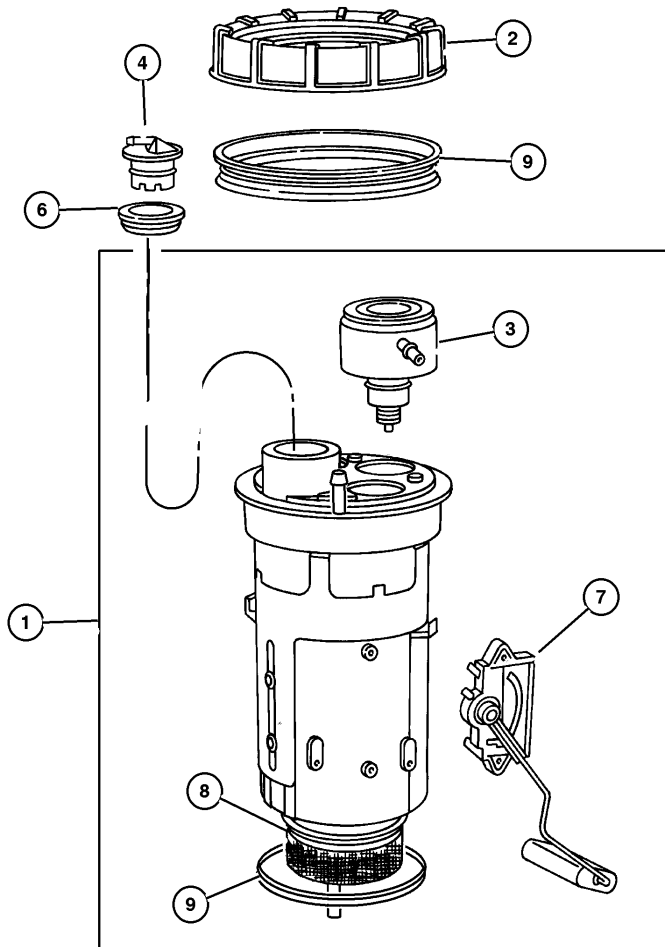

ITEM	PART NUMBER	QTY	LINE	SERIES	BODY	ENGINE	TRANS	DESCRIPTION
Note:[ELO]= All 5.2L Gas Engines,[EML]= 5.9L Magnum V-8 Engine, manual, 12 Disc Magazine. [EMO]= All 5.9L Gas Engines, [EWO]= All 8.0L Gas Engines, manual, 12 Disc Magazine. ETO= All 5.9L Diesel Engines manual, 12 Disc Magazine.								
1	4897 666AF	1				EMO, EWO		MODULE KIT, Fuel Pump/Level Unit 34 Gallon
	4897 667AF	1				EMO, EWO		35 Gallon
	4897 668AF	1				ETO		35 Gallon
						ETO		34 Gallon
2	5200 5389	1				EMO, EWO		NUT, Fuel Pump Module
3	4798 825	1				EMO, EWO		FILTER, Fuel Pressure Regulator
4								VALVE, Fuel Vapor, Service in Item #1, (NOT SERVICED)
-5	5212 7666	1				ETO		VALVE, Fuel Tank Rollover Safety
6	4616 244	1				EMO, EWO		GROMMET, Rollover Valve
7	4897 669AB	1				EMO, EWO		LEVEL UNIT KIT, Fuel
8								FILTER, Fuel, Serviced in Module, (NOT SERVICED)
9	5201 8808	1				EMO, EWO		SEAL, Fuel Pump and Level Unit

**DODGE RAM QUAD CAB/CLUB CAB (BE)**

SERIES	LINE	BODY	ENGINE	TRANSMISSION
L = Ram Truck (All)	2, 7 = 2500 3, 8 = 3500	33 = Quad Cab (138 WB) 34 = Quad Cab (154 WB)	ETC, ET0 = 5.9L Cummi Diesel ETH = 5.9LCummi HO Turbo Disl EML,EM0 = Magnum 5.9L V8 EMM,EM0 = 5.9L SMPI V8 EWA, EWO = 8.0L V10 MPI	DGP = 47RE 4 Speed Auto. DGT, DG0 = 46RE 4 Speed Auto. DDX, DDC = 5 Speed HD Manual DDP, DD0 = 5 Speed Manual DEE = 6 Speed HD Manual DBB = All Manual Transmissions

AR = Use as required - = Non illustrated part # = New this model year

December 11, 2001